

Klever Heavy Duty XChange XD

Safety Concealed Cutter
Heavy Duty XD Interchangeable Head

KLEVER XD X-CHG DX

Keep the Handle, Replace the Head!

The Klever Heavy Duty XChange XD offers the highest level of safety with its concealed blade that reduces cut injuries and damage to goods. **50% STRONGER** and **LAST 4X LONGER**. Cut faster and smoother with **SMOOTH-KUT** by preventing material clogging.



Heavy duty



Interchangeable blade heads



Reduce cut injuries

Features

Interchangeable replacement blade heads



Metal tape splitter extends blade life

Box cutting guide

Reduce waste by reusing the handle a cost effective & eco-friendly solution

Metal tape splitter

Lanyard hole easy to carry

50% STRONGER & LASTS 4X LONG

PROPRIETARY SMOOTH-KUT TECHNOLOGY

Easy release locking tab

Ergonomic "soft touch" handle reduces hand fatigue

Cuts more materials for more applications

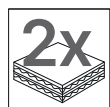

Thick double corrugated



Shrink wrap, film



Heavy duty strapping

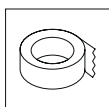

Adhesive tape



Bagged goods

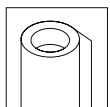

Rolled goods

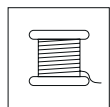

Yarn, string

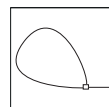

Zip ties



- Retail
- Office
- Safety
- Industrial
- Manufacturing
- Packaging
- Construction



Cutting Safety

45° ANGLE

LESS FORCE = EASIER WORK = LESS RISK OF INJURY

- Always cut in a 45° angle for an easier and safer cutting experience
- When cutting corrugated cardboard, tilt the knife slightly sideways to reduce necessary force
- Ensure that films and tapes are always taught before cutting them, the blade will cut your material better

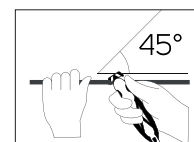

Signs of Wear & Tear

- Worn, gouged or chipped guard
- Worn tip
- Worn, dull or chipped blade
- Requires more force to cut
- Creates jagged cuts

MAINTAIN YOUR CUTTING SPEED & REPLACE BLADE HEAD WHEN WORN

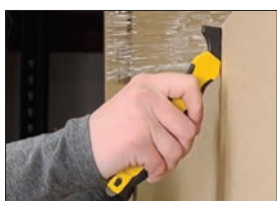
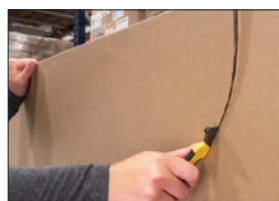

Diplomat
the cutting edge in safety

KLEVER

Klever Heavy Duty XChange XD

Safety Concealed Cutter
Heavy Duty XD Interchangeable Head

50% STRONGER &
LASTS **4X** LONGER

PROPRIETARY
SMOOTH-KUT™
TECHNOLOGY



The **KLEVER HEAVY DUTY XCHANGE XD** is an **EXTRA DURABLE** concealed blade safety cutter featuring a heavy duty blade head that's **50% STRONGER** and **LAST 4X LONGER** than similar cutters. Reduce plastic waste in your operations by reusing the handle and replacing the blade head. The proprietary **Smooth-Kut™** technology increases cutting speed by preventing corrugate from clogging the blade. ***Faster, smoother, and more ergonomic cutting!***

Features & Benefits

- Mix-and-match replacement heads based on the cutting application
- HIGHEST SAFETY LEVEL - Concealed blade reduces cut injuries, reduces damaged goods
- Thickset XD replaceable blade head offers exceptional durability
- Engineered to be 50% STRONGER and LAST 4X LONGER than similar cutters
- Proprietary Smooth-Kut™ technology prevents corrugate clogging in blade
- Suitable for left and right hand use
- Handle includes metal tape splitter
- Ergonomic 'Soft Touch' handle reduces hand fatigue and stress
- Simple quick-change, snap-in head
- Made & rigorously tested in the USA

Mounted Blade Head



KLEVER XD DX-HEADS - Heavy Duty XD head, ideal for cutting thicker materials; stronger, faster, smoother & prevents clogging

Accessories



KLEVER HOLSTER



LANYARD

Blade heads also available:

- DX-HEADS KLEEN
- DX-HEAD MP KLEEN
- X-HEADS KLEEN
- DD-HEADS
- DX-HD TI
- XHEAD TI

"Keep the handle, replace the head!"

Interchangeable, snap-in heads built for the entire line of KLEVER XCHANGE safety cutters

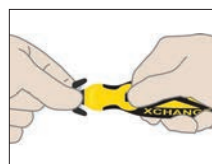

Grasp the head guard and handle firmly while pressing thumb down on the locking tab.

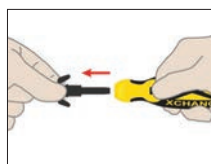

Pull the head from the handle.

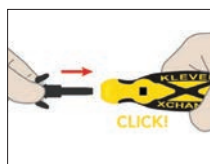

Important: Insert the new head until the locking tab clicks in place. The head should NOT pull back out without depressing the locking tab.



Interchangeable Replacement Heads



KLEVER X-HEADS - Dual-sided head, ideal for cutting thinner materials



KLEVER DX-HEADS - Wide head, ideal for cutting thicker materials



KLEVER DX-HEADS MP - Multipurpose head, in-built metal tape splitter & scraper; ideal for cutting thicker materials

KLEVER XD X-CHG DX

Product Details

Code: KLEVER XD X-CHG DX

Barcode: 9312932188741

Technical

MATERIAL	Reinforced plastic, Carbon steel
DIMENSIONS	L:178mm, W:10mm, H:45mm
WEIGHT	39 grams

Packaging

SELL PACK QTY	1 unit
INNER QTY	12 units
INNER DIMENSIONS	Bag
INNER WEIGHT	0.5 kg
OUTER QTY	144 units
OUTER DIMENSIONS	L:29cm, W:29cm, H:18cm
OUTER WEIGHT	6.5 kg

Why KLEVER?

Klever Innovations is a leader in developing concealed safety cutting solutions that keep workplace safety a top priority. Klever's signature "concealed blade" design significantly reduces cut injuries and damaged merchandise, resulting in significant cost savings for your organisation. All KLEVER safety cutters are proudly manufactured in the USA.

Contact us

Diplomat Blades (Aust) Pty Ltd

For samples, enquiries and orders please contact us today

1300 BLADES (252 337)

sales@diplomatblades.com.au

diplomatblades.com.au

